



BADGER FARM
Parish Council

Badger Bugle – Issue 4 | December 2022

BADGER FARM PARISH COUNCIL

Newsletter of Badger Farm Parish Council



Welcome

Welcome to the
December 2022
edition of The Bugle!



©2022 Badger Farm Parish Council. While endeavouring to make sure that all published information is accurate, the publishers cannot be held responsible for mistakes or omissions. Reproduction in whole or part of any of the text, illustrations or photography without the express written permission of the publisher is strictly forbidden. The opinions expressed in articles and accompanying literature are strictly those of the authors.

Designed and printed by
TLC Online, 023 8024 3044
www.tlc-online.co.uk

Our Councillors

Here is the team of seven parish councillors, elected to run the parish council in your best interests. As you can see, we have a vacancy for a parish councillor, why not put yourself forward to help your community. Contact the Clerk to find out more...

**Councillor John Godbold - Chairman**

22 Lark Hill Rise, Badger Farm, Winchester.
SO22 4LX

Mobile: 07711 112 643

Email: cllr.j.godbold@badgerfarm-pc.gov.uk

**Cllr. Helen Barlass**

28 Barley Down Drive, Badger Farm, Winchester,
Hampshire. SO22 4LS

Mobile: 07939 996 703

**Cllr. Ali Cochrane**

16 Honeysuckle Close, Badger Farm, Winchester,
Hampshire. SO22 4QQ.

Mobile: 07973 836 584

**Cllr. Rhian Dolby**

51 Broad Chalke Down, Badger Farm, Winchester,
Hampshire. SO22 4LR

Telephone: 01962 864 273

Mobile: 07798 554 065

**Cllr. Fenella Jarvis**

6 Swift Close, Badger Farm, Winchester,
Hampshire. SO22 4QG

Telephone: 01962 840 242

Mobile: 07753 821 064

**Cllr. Sarah McColl - Vice Chair**

7 Roydon Close, Badger Farm, Winchester,
Hampshire. SO22 4PY

Mobile: 07876 788 864

**Cllr. Alex Skinner**

28 Harvest Close, Badger Farm, Winchester,
Hampshire. SO22 4DW

Mobile: 07717 105 072

Vacancy

**Christine Howe
Clerk & RFO**

P.O. Box No. 2419, Fordingbridge.SP6 9BQ

Mobile: 07463 760 801

Notes from the Editor

Welcome to the winter edition of the Badger Bugle!



Councillors update:

Firstly, some announcements. We are sorry to announce that Jackie Johnston has resigned her position as councillor. Thank you to Jackie for her work with Badger Farm Parish Council. There is, therefore, a vacancy for the position of parish councillor. Please contact the Clerk in the first instance if you are interested in becoming a parish councillor.



Sarah McColl

Cllr Sarah McColl has recently been elected to serve as our Vice Chairman. This ensures that there is a clear line of command if the Chairman is unable to attend a meeting for any reason.

Memorial Bench

A delay with the manufacturer means that we have not taken delivery of the planned jubilee bench! In view of the sad passing of Her Majesty Queen Elizabeth in September, we have arranged to change the design of the bench on order. We will now be getting a bench as a memorial to Her Majesty. Hopefully, problems at the manufacturers will be resolved soon and we can look forward to taking delivery of the new memorial bench.

Photography Competition

We are intending to run a photography competition again next year as it proved popular with residents. Next year we are also planning to hold a gardening competition. If you have any other ideas of fun ways to get the community spirit going, please do let us know via the Clerk.

Please accept our best wishes for a happy and healthy festive season from all at Badger Farm Parish Council



Cllr Rhian Dolby
Editor, The Badger Bugle

Cost of living crisis



As the weather gets colder, we are all worrying about how we can afford to stay warm this winter. Government money is available for those struggling to pay for fuel and food through the connect4communities initiative
<https://www.hants.gov.uk/socialcareandhealth/childrenandfamilies/connectforcommunities/supportforfamilies>



The local library can be used as a warm space in which to work, study or meet friends. So can the Chat-Tea Café at Badger Farm Community Centre. The next session is due on 19 December 2-4pm.
<https://www.chat-tea.co.uk/where-to-find-us.html>



Hampshire County Council offers grants of up to £5,000 to community organisations working to support residents and communities.
<https://www.hants.gov.uk/costofliving/community-support>



Winchester City Council have gathered information together on benefits, housing, and energy etc on a dedicated website.
<https://www.winchester.gov.uk/cost-of-living>

Badger Farm Parish Council offers small grants to local groups providing valuable services to the local community.

A grant has recently been awarded to Winchester Citizen's Advice Bureau who are doing sterling work supporting vulnerable people locally.



Bushfield Camp Consultation

Consultation has opened for public comment on the viability of proposals to develop Church Commissioners' land at Bushfield Camp. Developers Legal & General and Gisborne are proposing a 'mixed use scheme' hoping to attract leading employers to the area. Winchester City Council have previously designated the land suitable for employment.

The former army base has been disused since the 1970s and much of the land in question is undeveloped chalk downland and home to a very wide variety of species (both flora and fauna). Local people have already expressed the desire to keep some of the land as a nature reserve and for it to remain a public space.

<https://www.bushfieldcampregeneration.co.uk>

A consultation event took place at Badger Farm Community Centre on Sunday 20 November. Further public consultation events are planned in the coming months.

All properties on Badger Farm will have received an update through the post from the developers with news of this consultation event. Please do keep an eye out on our website and noticeboards for news on forthcoming consultations.

You can also visit the dedicated website for further information, as well as copies of the exhibition boards shown at the consultation event.



M3 J9-14 Safety Barrier Improvements update

The plans to upgrade the M3 between Junctions 9 and 14 to a Smart motorway have been paused by the Government while five years' data is being gathered. In the meantime, work to replace the central reservation safety barrier through this section has begun. The steel barrier is being replaced with concrete, which will provide greater protection and require less maintenance over a longer life span.

This will, however, require the removal of the existing barriers, posts and concrete foundation and installation of new drainage before

the new concrete barrier can be installed. To create a safe working area and maintain the capacity of the road, three narrow lanes and a 50mph speed limit are in place in each direction, using the hard shoulder as a running lane.

Work is currently taking place during daytime with no planned overnight closures in the next few months. Signs advise works will continue until summer 2023. More details: www.nationalhighways.co.uk/our-roads/south-east/m3-junctions-9-to-14-smart-motorway/

Repair Café



Repair Café is an international movement spanning from the Netherlands to Europe, the UK, the US and Asia.

A group of volunteers are undertaking the set-up of a Repair Café for Winchester. The push for volunteers was launched during WinACC's Green Week. Events were held at both Unit 12, Winnall and Badger Farm Community Centre.

Both events proved to be a big success with many people coming forward to volunteer for roles ranging from hospitality, to repairing, to management and administration.

The dual locations have been chosen to reduce the amount of travel people in Winchester need to do to access the service.

Repair Café Winchester will be an independent charity and will forge links with many of the local community organisations.

The aim is to work collaboratively with all to repair and re-use goods, share knowledge and reduce our carbon impact.

While the Repair Café Winchester will launch next year there is lots of work behind the scenes to do to make sure they can provide the best service they can, so do contact them



if you wish to volunteer as a repairer or in whatever other capacity winchesterrepaircafeuk@gmail.com or visit <https://www.repaircafe.org/en/>





Hampshire Archives & Local Studies

If you are interested in the history of the local area, seeing archive film material, or researching your family history roots, the place to visit is the local record office opposite the train station in Winchester.

HALS is a treasure trove of over 1,000 years of written history of Hampshire run by Hampshire

County Council. Access is free and staff are on hand to help guide your research.



<https://www.hants.gov.uk/librariesandarchives/archives/visit-us>

The History of Badger Farm

I have spent some time drawing together a timeline of the history of Badger Farm from sources held at HALS. The intention is to have a fuller article on the history of the parish available on our website by January. Hopefully, the website will also include some more of the images I took during my research.

Many of you know that Badger Farm was named after William Badger, a former alderman and three-time mayor of Winchester. It is difficult to give concrete dates for 'the' William Badger as there at least three generations of the family all called William Badger in the records! This makes definite dating quite complex. Fuller information on this will be available on the website soon. Suffice it to say, I have found a reference to the death of a William Badger in 1602 (Compton near Winchester by J S Drew, 1939, page 88) which casts doubt on

the assertion made in the History of Parliament that William Badger lived to be over a hundred! <https://www.historyofparliamentonline.org/volume/1558-1603/member/badger-william-1523-1629>

At Domesday, the land that was later to be called Badger Farm was held by Bishop Walkelin and was part the manor of Barton Priors. In 1541, following the dissolution of the monasteries, Henry VIII granted to the Dean and Chapter of Winchester the "property of the late monastery of St Swithun, manor of Barton Priors..." This was the new foundation of the Dean and Chapter which was endowed with (amongst other places) Barton Priors. William Badger became Chamberlain in 1553 and by 1565 he was a tenant of the Dean and Chapter of Winchester Cathedral on the land now named after him. William and his sons were tenants through to at least 1615.

William Badger became mayor for the first time in 1572 and Clerk of the lands of the diocese in 1575. From 1580 he acted jointly with his son Robert in the role of Clerk. When Queen Elizabeth I granted a charter to the city of Winchester in 1588, William Badger is mentioned as an alderman for life. The charter is a magnificent document and one of the finest treasures held at the record office (ref: W/A1/25/1). The first documented reference to the name Badger [Badger's] Farm comes in 1649 in a Civil War (Parliamentary) survey of Dean and Chapter lands. In 1788, the Dean

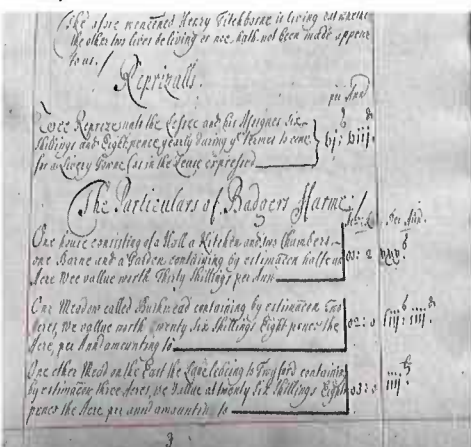

**1649 survey - Courtesy of the Dean and Chapter of Winchester Cathedral:
Hampshire Record Office: ref: DCJ/10/2/2**

and Chapter leased Badger Farm to Richard Goldfinch of Compton. The Goldfinch family occupied the land continuously through to at least the time of the tithe map in the 1840s. In the 1930s the Church Commissioners sold the land to Mr H D Shingleton, and subsequent owners sold it to a development company. However,

you can see that in 1940 Badger Farm is still open farmland, although Bushfield Camp is now visible.

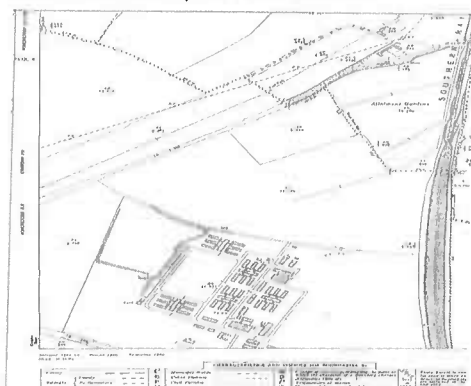

**Badger Farm Ordnance Survey 1940 map
Courtesy of Hampshire Record Office: ref: OS
50.1, 1940**

Several planning applications to develop Badger Farm were refused during the 1960s. A development brief was finally published in April 1973 emphasising the importance that any development should be sympathetic to the chalk downland and historic nature of Winchester. Developers were required to build a 'western distributor road' (Badger Farm Road) before development could start, and no vehicular access was to be allowed through Stanmore. In 1985, Badger Farm was created as a separate parish and our first representative on Winchester City Council was Cllr Paul Heinrich of the Liberal Party.

Please do visit Hampshire Record Office to see some of the wonderful documents they hold relating to the history of Hampshire and check out our website in the new year for the full article on the history of the parish.

Cllr R Dolby